

**TURCK**

Your Global Automation Partner

# IMXK12-DI...

# Isolating Switching Amplifier



# Contents

<b>1</b>	<b>About this document</b>	<b>5</b>
<b>2</b>	<b>Scope</b>	<b>5</b>
<b>3</b>	<b>Safety Integrity Level</b>	<b>5</b>
<b>4</b>	<b>Product description</b>	<b>5</b>
4.1	Safety function	6
4.2	Safe state	6
<b>5</b>	<b>Safety-Planning</b>	<b>6</b>
5.1	Architectural specifications	7
5.2	Assumptions	7
5.3	FMEDA results	7
5.4	Examples for using the results	8
5.4.1	Probability of dangerous failure per hour (High Demand mode)	8
5.4.2	Average probability of dangerous failure on demand (Low Demand mode)	8
<b>6</b>	<b>Operating Instructions</b>	<b>9</b>
6.1	General	9
6.2	Before Operation	10
6.2.1	Parameterization	12
6.3	Operation	13
6.4	After Operation	13
<b>7</b>	<b>Appendix: Connection and wiring diagrams</b>	<b>14</b>
7.1	Output Relay	14
7.1.1	IMXK12-DI01-1S-1R	14
7.2	Output Transistor	15
7.2.1	IMXK12-DI01-1S-1T	15
7.3	Output Push-Pull	16
7.3.1	IMXK12-DI01-1S-1PP	16
<b>8</b>	<b>Appendix: Terms and abbreviations</b>	<b>17</b>
<b>9</b>	<b>Appendix: Proof tests</b>	<b>17</b>
<b>10</b>	<b>Appendix: Document history</b>	<b>18</b>
<b>11</b>	<b>Appendix: Certificate</b>	<b>18</b>



## 1 About this document

This safety manual contains all information that is required by users to operate the device in functional safety systems. Read this manual carefully before using the device.

This document addresses only functional safety according IEC 61508. Other aspects, such as intrinsic safety, are not considered.

All instructions must be followed in order to assure functional safety.

Always make sure that this is the latest version of the safety manual at [www.turck.com](http://www.turck.com). The English version is considered the definitive document. Care was taken in the production of the translations of this document. If there is any uncertainty in its interpretation, refer to the English version of the safety manual or contact TURCK directly.

## 2 Scope

This safety manual is valid for the following devices.

ID	Product Name	Number of Channels	Clamps	Intrinsic Safety	Variant
100000679	IMXK12-DI01-1S-1R-0/24VDC	1	screw clamps	yes	IMXK12-DI01-1S-1R
100000680	IMXK12-DI01-1S-1R-0/24VDC/CC	1	spring clamps	yes	IMXK12-DI01-1S-1R
100000681	IMXK12-DI01-1S-1T-0/24VDC	1	screw clamps	yes	IMXK12-DI01-1S-1T
100000682	IMXK12-DI01-1S-1T-0/24VDC//CC	1	spring clamps	yes	IMXK12-DI01-1S-1T
100000683	IMXK12-DI01-1S-1PP-0/24VDC	1	screw clamps	yes	IMXK12-DI01-1S-1PP
100000684	IMXK12-DI01-1S-1PP-0/24VDC/CC	1	spring clamps	yes	IMXK12-DI01-1S-1PP

## 3 Safety Integrity Level

The devices are rated to a SIL of

**SIL2, SC3**

## 4 Product description

The isolating switching amplifiers are used for the galvanically isolated transmission of binary signals from sensors and mechanical contacts. Sensors acc. to EN 60947-5-6 (NAMUR) or mechanical contacts can be connected.

The output circuit is isolated from the input circuit and is either designed as relay output or potentially isolated transistor output or potential output.

## 4.1 Safety function

<b>IMXK12-DI01-1S-1R</b>	According to the input signal and the configuration (linemonitoring, effective direction, mapping of inputs and outputs) the relay output is within 20 ms de-energized.
<b>IMXK12-DI01-1S-1T</b>	According to the input signal and the configuration (linemonitoring, effective direction, mapping of inputs and outputs) the transistor output is within 20 ms blocked.
<b>IMXK12-DI01-1S-1PP</b>	According to the input signal and the configuration (linemonitoring, effective direction, mapping of inputs and outputs) the output is within 20 ms < 1 V.

See “6.2.1 Parameterization“ on page 12 for input signals and configuration.

The products can be used with a hardware fault tolerance  $HFT = 0$ , e.g. in a 1oo1 architecture up to SIL 2 and with a hardware fault tolerance  $HFT = 1$ , e.g. in a 1oo2 architecture up to SIL 3, dependent of the application.

The LED is not part of the safety-function.

## 4.2 Safe state

<b>IMXK12-DI01-1S-1R</b>	In the safe state the relay output is de-energized.
<b>IMXK12-DI01-1S-1T</b>	In the safe state the transistor is blocked.
<b>IMXK12-DI01-1S-1PP</b>	In the safe state the output is < 1 V.

Faults do not have to be acknowledged. If the fault is rectified, the device automatically resumes operation and leaves the safe state.

# 5 Safety-Planning

This chapter provides information for planning a safety-related loop.

The device is not specified for a certain application. Make sure that the data provided in this chapter is valid for your target application.

Special application-specific factors may cause the premature wear of the device and must be taken into consideration when planning systems; take special measures to compensate for a lack of experience based values, e.g. through implementation of shorter test intervals.

The suitability for specific applications must be assessed by considering the particular overall safety-related system with regard to the requirements of IEC 61508.

Safety-planning must only be carried out by trained and qualified personnel. If there is any doubt contact TURCK directly.

## 5.1 Architectural specifications

Due to architectural considerations the following characteristics are specified:

Type	A
HFT	0

Experience has shown that the useful lifetime often lies within a range of 8 to 12 years. It can be significantly less if elements are operated near their specification limits. However, it can be extended by appropriate measures. For example, heavy temperature fluctuations could potentially decrease the useful lifetime, as constant temperature below 40 °C could potentially increase the useful lifetime.

For the relay outputs ( $\cos \phi = 1, I = 2 \text{ A AC}$ ) the useful lifetime is 8 to 12 years or 50.000 switching cycles.

## 5.2 Assumptions

- Failure rates are constant for 10 years, wear out mechanisms are not included
- Propagation of failures is not relevant
- External power supply failure rates are not included
- All components that are not part of the safety function and cannot influence the safety function (feedback immune) are excluded.
- The activations of line-monitoring can improve the results

## 5.3 FMEDA results

The following safety characteristic are the results of the FMEDA.

According to the configuration (inversion-mode, line-monitoring) the results of the FMEDA vary. In this case the worst-case configuration is regarded

Variant	$\lambda_{SD}$	$\lambda_{SU}$	$\lambda_{DD}$	$\lambda_{DU}$	No effect	SFF	DC
IMXK12-DI01-1S-1R	4 FIT	246 FIT	7 FIT	94 FIT	245 FIT	73 %	6 %
IMXK12-DI01-1S-1T	4 FIT	213 FIT	7 FIT	77 FIT	221 FIT	74 %	8 %
IMXK12-DI01-1S-1PP	4 FIT	271 FIT	7 FIT	88 FIT	291 FIT	76 %	7 %

The stated Safe Failure Fraction (SFF) is for reference only. The complete subsystem will need to be evaluated to determine the overall SFF.

The failure rates used in this analysis are the basic failure rates from the Siemens standard SN 29500 based on the average ambient temperature of components of 40 °C.

“No effect” is a failure mode of a component that plays part in implementing the safety function but is neither a safe nor a dangerous failure. According to IEC 62061, it would be possible to classify the “No effect” failures as “Safe Undetected” failures. Not doing so represents the worst-case.

## 5.4 Examples for using the results

### 5.4.1 Probability of dangerous failure per hour (High Demand mode)

The PFH values are based on a worst-case diagnostic test rate and a reaction time of 20 ms. The ratio of the diagnostic test rate to the demand rate shall equal or exceed 100.

	PFH
IMXK12-DI01-1S-1R	9.352 E-08 1/h
IMXK12-DI01-1S-1T	7.657 E-08 1/h
IMXK12-DI01-1S-1PP	8.765 E-08 1/h

### 5.4.2 Average probability of dangerous failure on demand (Low Demand mode)

With the FMEDA results and the values specified in the following table the average frequency of dangerous failure can be calculated exemplarily:

$T_1$	8760 h
MTTR	24h

Variant	PFD <sub>avg</sub>
IMXK12-DI01-1S-1R	4.12 E-04
IMXK12-DI01-1S-1T	3.37 E-04
IMXK12-DI01-1S-1PP	3.86 E-04

## 6 Operating Instructions

### 6.1 General

- ▶ The device must be registered online: [www.turck.com/SIL](http://www.turck.com/SIL)
- ▶ The device must only be carried out, fitted, installed, operated, commissioned and maintained by trained and qualified personnel.
- ▶ The device is not specified for a certain application. Make sure that application-specific aspects are considered.
- ▶ Data from other documents, e.g. data sheets, is not valid for functional safety operation. Devices must be used in cabinets in an typical industrial field environment only. The following restrictions describe the operation and storage conditions:
  - ▶ Ensure that the environment complies with the following ratings

Minimum ambient temperature	-25 °C
Maximum ambient temperature	70 °C
Minimum storage temperature	-40 °C
Maximum storage temperature	80 °C
Maximum air humidity	95 %
Minimum air pressure	80 kPa
Maximum air pressure	110 kPa

- ▶ The average temperature over a long period of time directly on the exterior sidewall of the housing must be maximum 40 °C.
  - The temperature on the exterior sidewall of the housing can deviate considerably from the temperature in the control cabinet.
  - The temperature on the exterior sidewall of the housing must be observed in a steady state.
  - In case the temperature on the exterior sidewall of the housing is higher, the failure rates from “5.3 FMEDA results” on page 7 must be adjusted:
    - For a higher average temperature of 60 °C on the exterior sidewall of the housing, the failure rates are multiplied by an experience factor of 2.5.
- ▶ Ensure that sufficient heat dissipation is provided.
- ▶ Protect the device from radiated heat and severe temperature fluctuations.
- ▶ Protect the device from dust, dirt, moisture, shock, vibration, chemical stress, increased radiation and other environmental influences.
- ▶ Ensure a degree of protection of at least IP20 according to IEC 60529 at the mounting location.
- ▶ Ensure that the electromagnetic stress does not increase the requirements of IEC 61326-3.1.
- ▶ If there is a visible error, e.g. defective housing the device must not be used.
- ▶ During operation of the device, surface temperatures may occur that could lead to burns if touched.
- ▶ The device must not be repaired. If problems occur with regard to functional safety, TURCK must be notified immediately and the device must be returned immediately to:

TURCK GmbH  
Witzlebenstraße 7  
45472 Mülheim an der Ruhr  
Germany

## 6.2 Before Operation

- ▶ Fasten the device to a rail according EN 60715 (TH35) as follows:

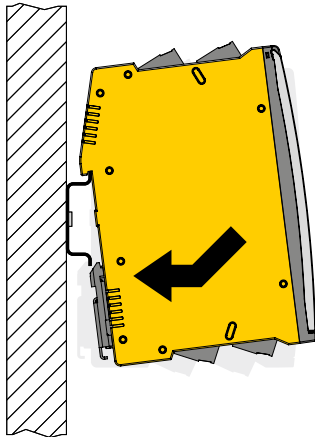

Fig. 1: Fasten the device

- ▶ Connect cables according to the wiring diagrams in “7 Appendix: Connection and wiring diagrams” on page 14
- ▶ Use cables with Terminal cross section
  - rigid: 0.2 mm<sup>2</sup> to 2.5 mm<sup>2</sup> or
  - flexible 0.2 mm<sup>2</sup> to 2.5 mm<sup>2</sup>
- ▶ When wiring with stranded wires: Fix the wiring ends with ferrules.

Connection via screw terminals:

- ▶ Insert the stripped cable ends (7 mm) in the guides of the cable glands.
- ▶ Fasten the screws with a screwdriver (max. tightening torque 0.5 Nm) to affix the cable ends.

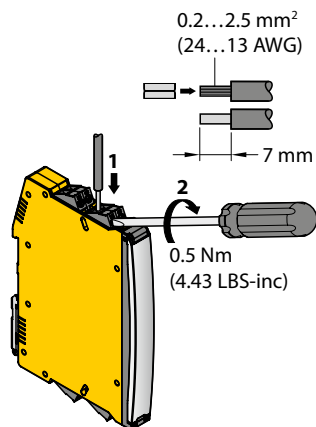

Fig. 2: Connection with screw terminals

## Connection with spring-type terminals

- ▶ Push the opening lever with a suitable screwdriver.
- ▶ Insert the stripped cable ends (7 mm) in the guides of the spring-type terminals.
- ▶ Pull the screwdriver to fix the cable ends.

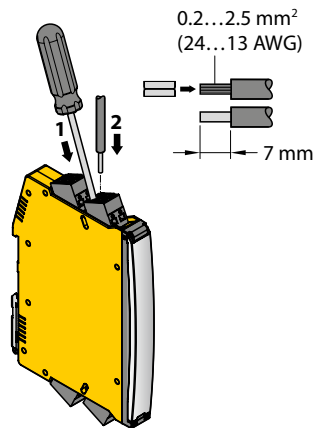

Fig. 3: Connection with spring-type terminals

- ▶ Make sure that only suitable equipment, e.g. sensors, are connected to the device.
- ▶ Make sure that a suitable power supply with the following characteristic is used:

Minimum voltage	10 VDC
Maximum voltage	30 VDC
Minimum Power	4 W

The relay outputs shall be protected by a fuse that limits the current to 2 A to avoid contact welding.

## 6.2.1 Parameterization

The safety function depends on the parameterization via DIP switches. The following switches are available:



Fig. 4: Parameterization Switches

Switch	Description
NC / NO	“Normally closed” (NC) or “Normally open” (NO) operation. See table below for details.
LM / off	Line monitoring for wire break and short circuit activated (LM) or deactivated (off). See table below for details.

The following table describes the cases for the execution of the safety function

- “IMXK12-DI01-1S-1R: The relay output is within 20 ms de-energized”
- “IMXK12-DI01-1S-1T: The transistor output is within 20 ms blocked”
- “IMXK12-DI01-1S-1PP: The output is within 20 ms < 1 V”

depending on the input signal and the parameterization:

input signal (sensor state) according IEC 60947-5-6	LM / off	NC / NO
wire break	off	NO
	LM	NC or NO
short circuit	off	NC
	LM	NC or NO
open	LM or off	NO
closed	LM or off	NC

## 6.3 Operation

- ▶ If the device is used in low demand mode, proof tests shall be executed periodically according to T1.
- ▶ Ensure that the plug connections and cables are always in good condition.
- ▶ The device must be replaced immediately if the terminals are faulty or the device has any visible faults.
- ▶ If cleaning is required, do not use any liquid or statically charging cleaning agent. Perform proof tests after each cleaning.
- ▶ The proof test shall be executed each time after installation and parameterization in order to check the requested function.
- ▶ The LED State is not part of the safety function.
- ▶ The DIP switches shall not be modified during operation. The device shall be locked against unintended operation/modification.
- ▶ The input frequency shall not exceed the following values:

Variant	Maximum input Frequency (provided Duty Cycle Signal 50%)
IMXK12-DI01-1S-1R	15 Hz
IMXK12-DI01-1S-1T	10 kHz
IMXK12-DI01-1S-1PP	15 kHz

## 6.4 After Operation

- ▶ Undo the terminal connection on the device.
- ▶ Remove the device from its rail fixing as shown in the figure:

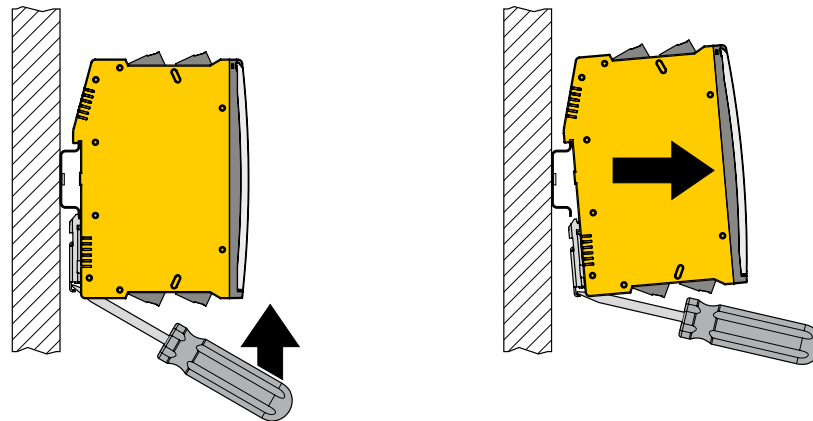

Fig. 5: Remove device

- ▶ Ensure the proper disposal of the device.

## 7 Appendix: Connection and wiring diagrams

The pin number assignment can be found at the front label.

### 7.1 Output Relay

Output relay – Load curve

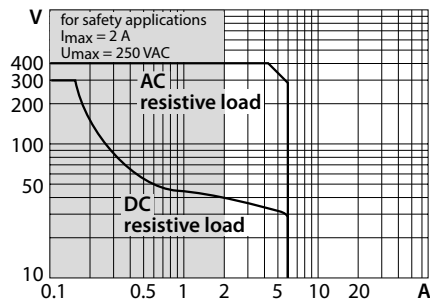

Fig. 6: Output relay load curve

#### 7.1.1 IMXK12-DI01-1S-1R

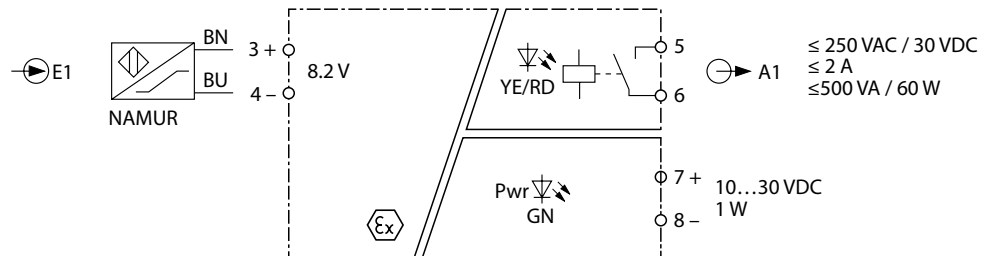

Fig. 7: Block diagram IMXK12-DI01-1S-1R

## 7.2 Output Transistor

### Semiconductor output (A1) ratings:

Switching voltage:  $\leq 30\text{ V}$

Switching current:  $\leq 100\text{ mA}$

### 7.2.1 IMXK12-DI01-1S-1T

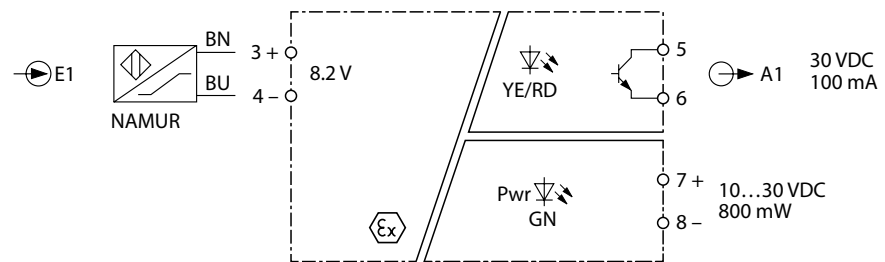

Fig. 8: Block diagram IMXK12-DI01-1S-1T

### 7.3 Output Push-Pull

**Semiconductor output (A1) ratings:**

Output voltage high: 28.5 V...30.5 V

Output voltage low: < 1 V

Switching current: ≤ 10 mA

#### 7.3.1 IMXK12-DI01-1S-1PP

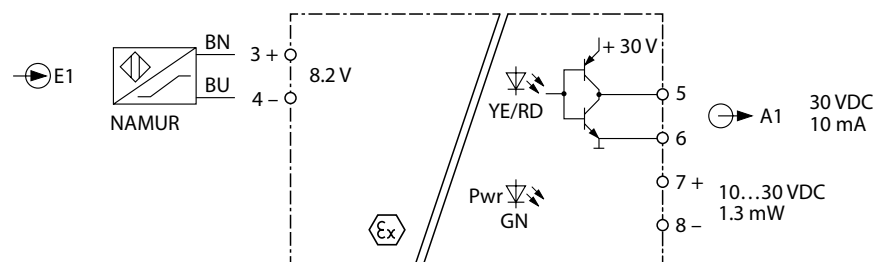

Fig. 9: Block diagram IMXK12-DI01-1S-1PP

## 8 Appendix: Terms and abbreviations

<b>DC</b>	Diagnostic Coverage
<b>FIT</b>	1 FIT is 1 failure per 10E09 hours
<b>FMEDA</b>	Failure Modes, Effects and Diagnostic Analysis
<b>HFT</b>	Hardware failure tolerance
<b>λAU</b>	Undetected Annunciation failure rate (per hour) Annunciation failures do not directly impact safety but impact the ability to detect a future fault (such as a fault in diagnostic circuit).
<b>λDD</b>	Detected dangerous failure rate (per hour)
<b>λDU</b>	Undetected dangerous failure rate (per hour)
<b>λSD</b>	Detected safe failure rate (per hour)
<b>λSU</b>	Undetected safe failure rate (per hour)
<b>MTTR</b>	Mean time to restoration (hour)
<b>PFDavg</b>	Average probability of failure on demand
<b>PFH</b>	Probability of dangerous failure per hour
<b>SFF</b>	Safe Failure Fraction
<b>SIL</b>	Safety Integrity Level
<b>T1</b>	Proof test interval (hour)
<b>Type A</b>	"Non-complex" element (all failure modes are well defined); for details see 7.4.4.1.2 of IEC 61508-2
<b>Type B</b>	"Complex" element (using micro controllers or programmable logic); for details see 7.4.4.1.3 of IEC 61508-2

## 9 Appendix: Proof tests

Proof tests shall be undertaken to reveal dangerous faults which are undected by diagnostic tests. This means that it is necessary to specify how dangerous undetected faults which have been noted during the FMEDA can be detected during proof testing.

Ensure that the proof test is only carried out by qualified personnel.

A suggested proof test consists of the following steps:

Step	Action
1.	Bypass the safety functions and take appropriate action to avoid a false trip.
2.	Provide appropriate input-/control signals to the interface modules and verify the expected signal input/output conditions for the interfaces.
3.	Verify if internal fault detection is working in case it is activated.
4.	Provide appropriate input-/control signals to the interface modules and verify that the safety function is carried out correctly.
5.	Remove the bypass and otherwise restore normal operation.

Once the test has been completed, document and archive the results.

## 10 Appendix: Document history

Document Version	Date	Modifications
1.0	2019-05-02	Initial version
2.0	2026-01-29	– SC3 added – Description added: capability of use in a 1oo2 architecture up to SIL 3 with a hardware fault tolerance HFT = 1, depending on the application – SIL card removed

---

## 11 Appendix: Certificate

The certificate can be found on the internet at [www.turck.com](http://www.turck.com).



# TURCK

Your Global Automation Partner

Over 30 subsidiaries and  
60 representations worldwide!

100004879 | 2026/01



[www.turck.com](http://www.turck.com)